

Geauga County Engineering Department
No Passing Zone Log

Route: **0007A (THOMPSON RD)**
 Length: **0.474** Direction: **East**

From: **0.000 COUNTY LINE**
 To: **0.474 LEROY RD**

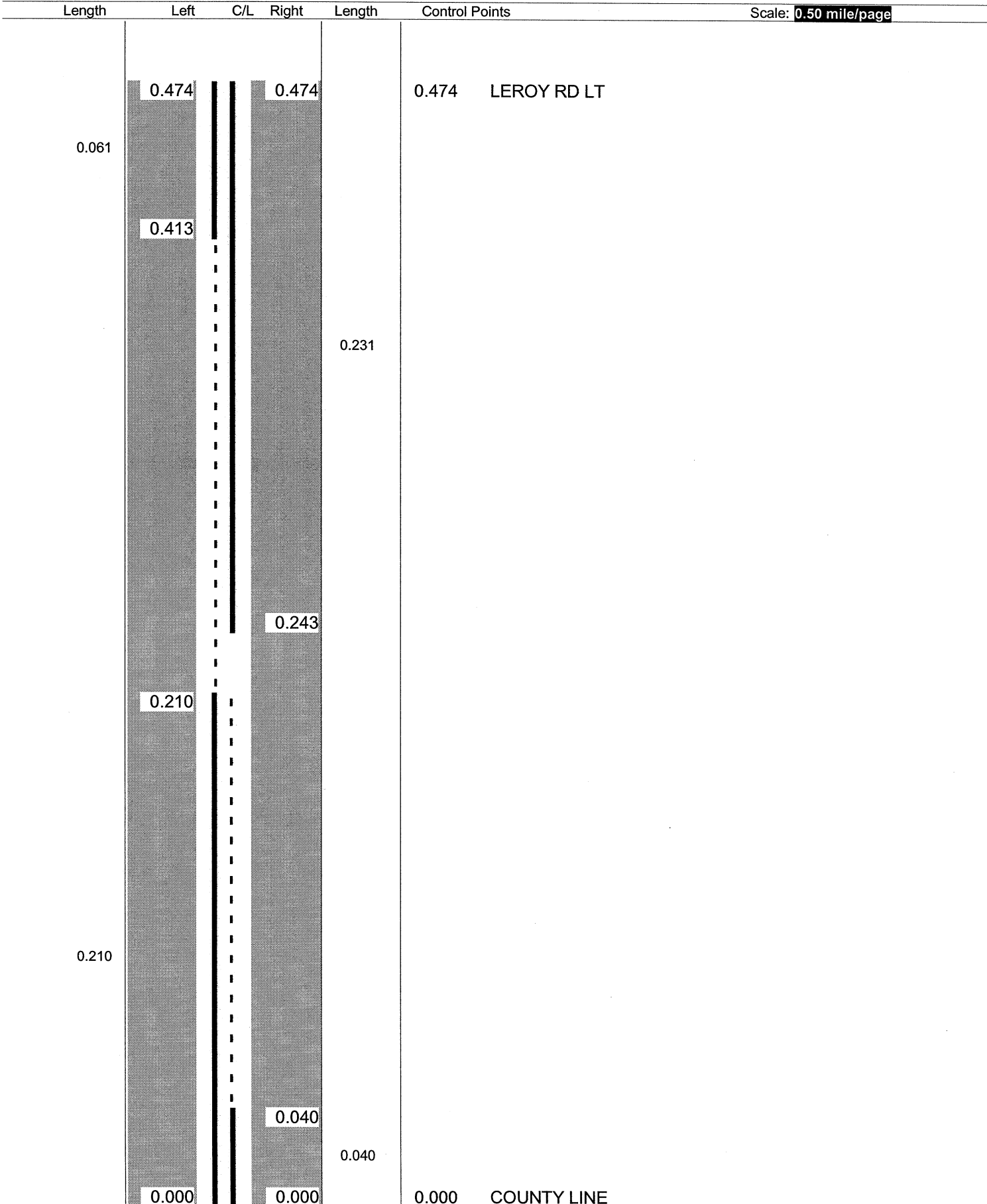

Sheet total equivalent length of solid line: 0.635

Accum. total: 0.635

Geauga County Engineering Department
No Passing Zone Log

Route: **0007C (THOMPSON RD)**
 Length: **0.432** Direction: **East**

From: **0.785 TRASK RD**
 To: **1.217 CLAY ST**

Length	Left	C/L	Right	Length	Control Points	Scale: 1.00 mile/page
0.061	0.846 0.785				0.785 TRASK RD LT	

Geauga County Engineering Department

No Passing Zone Log

Route: **0007C (THOMPSON RD)**
 Length: **0.432** Direction: **East**

From: **0.785 TRASK RD**
 To: **1.217 CLAY ST**

Length	Left	C/L	Right	Length	Control Points
0.022	1.217 1.195		1.217 1.046	0.171	1.217 CLAY ST

Sheet total equivalent length of solid line: 0.242

Accum. total: 0.357

Geauga County Engineering Department
No Passing Zone Log

Route: **0007D (THOMPSON RD)**
 Length: **0.673** Direction: **East**

From: **1.217 CLAY ST**
 To: **1.890 DEWEY RD**

