

Geauga County Engineering Department

No Passing Zone Log

Route: **0028A (TAYLOR WELLS RD)**
 Length: **2.472** Direction: **North**

From: **0.000 CR 3 CLARIDON TROY RD**
 To: **2.472 US 322**

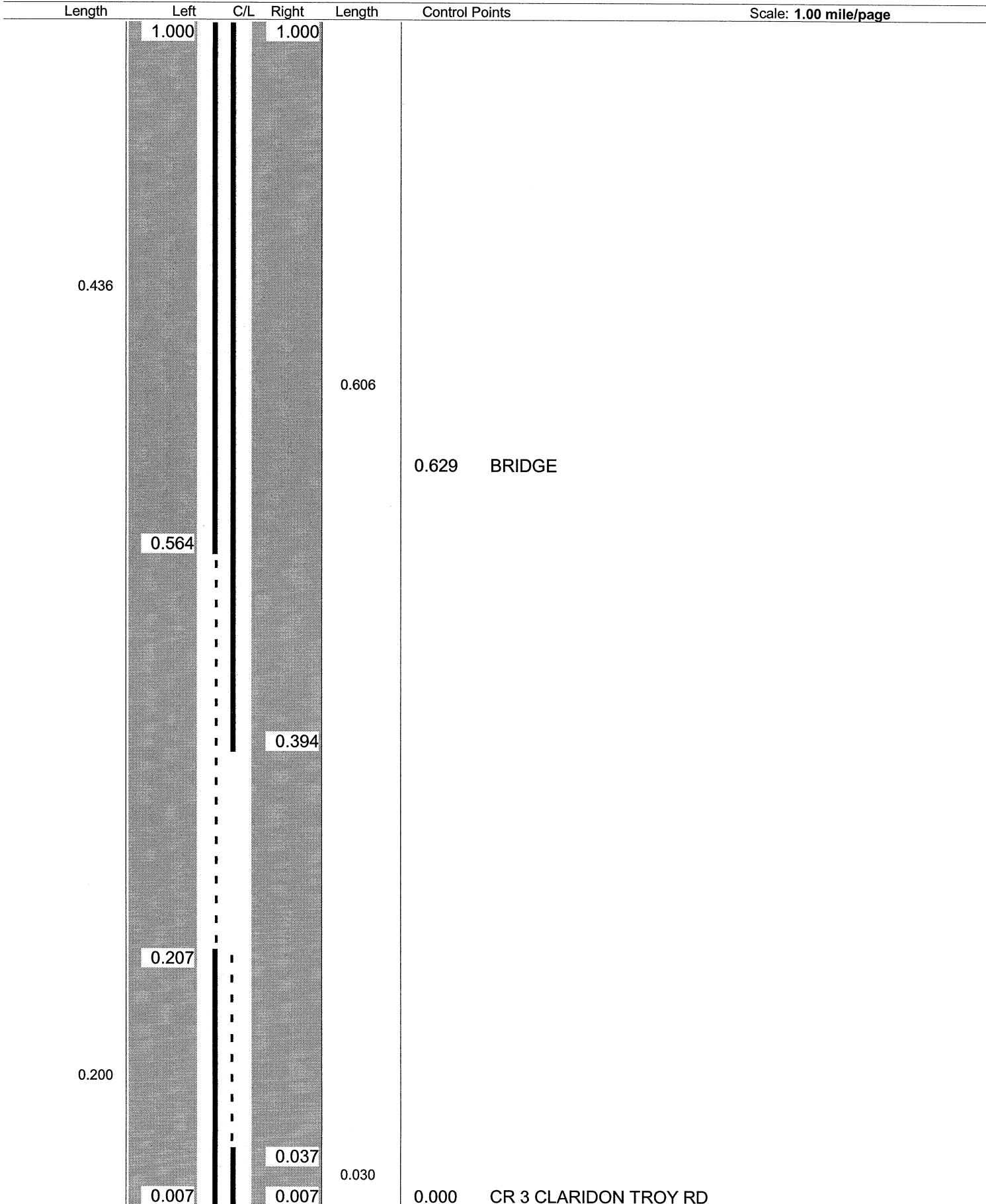

Sheet total equivalent length of solid line: 1.406

Accum. total: 1.406

Geauga County Engineering Department
No Passing Zone Log

Route: **0028A (TAYLOR WELLS RD)**
 Length: **2.472** Direction: **North**

From: **0.000 CR 3 CLARIDON TROY RD**
 To: **2.472 US 322**

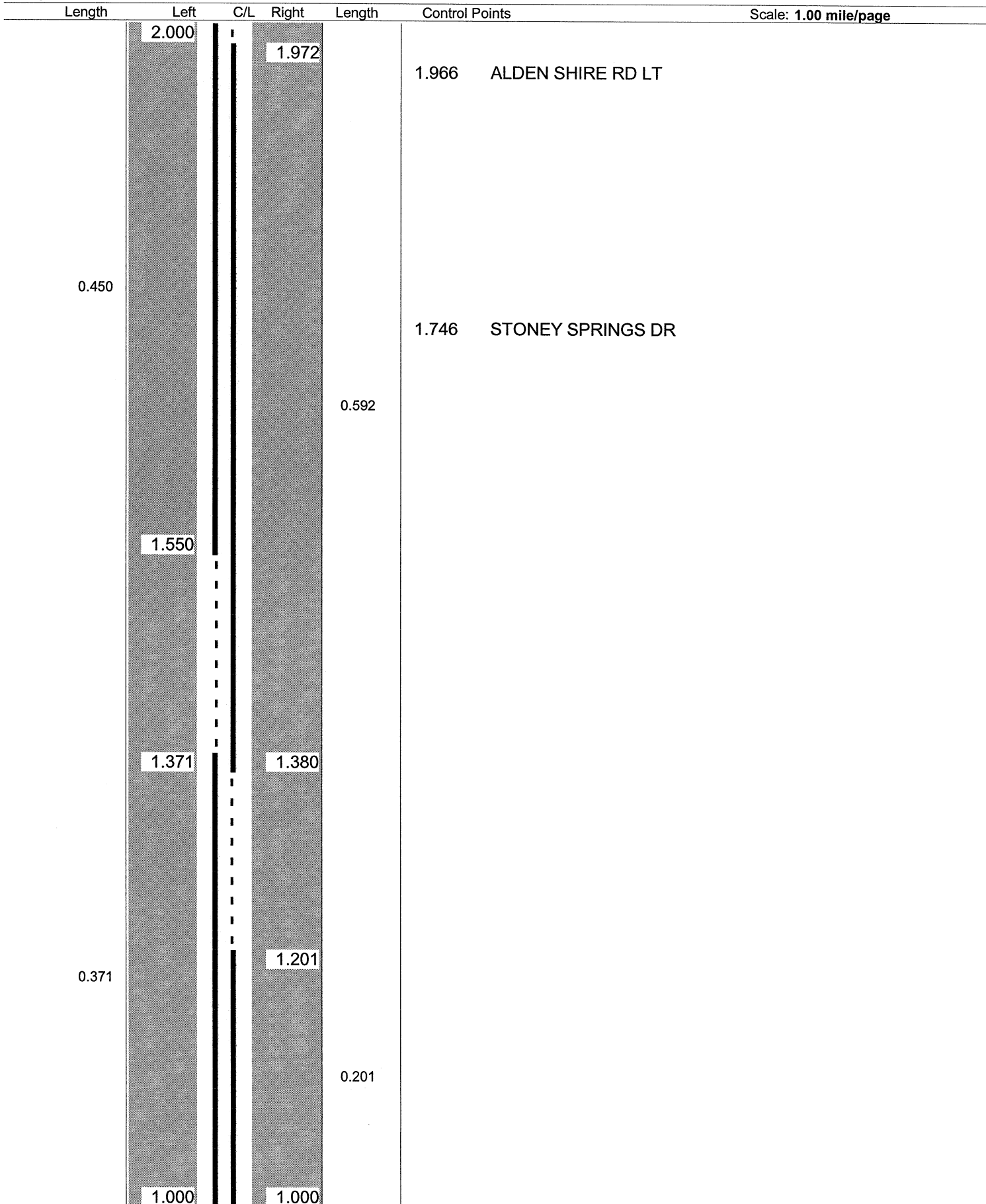

Sheet total equivalent length of solid line: 1.708

Accum. total: 3.114

Geauga County Engineering Department
No Passing Zone Log

Route: **0028A (TAYLOR WELLS RD)**
 Length: **2.472** Direction: **North**

From: **0.000 CR 3 CLARIDON TROY RD**
 To: **2.472 US 322**

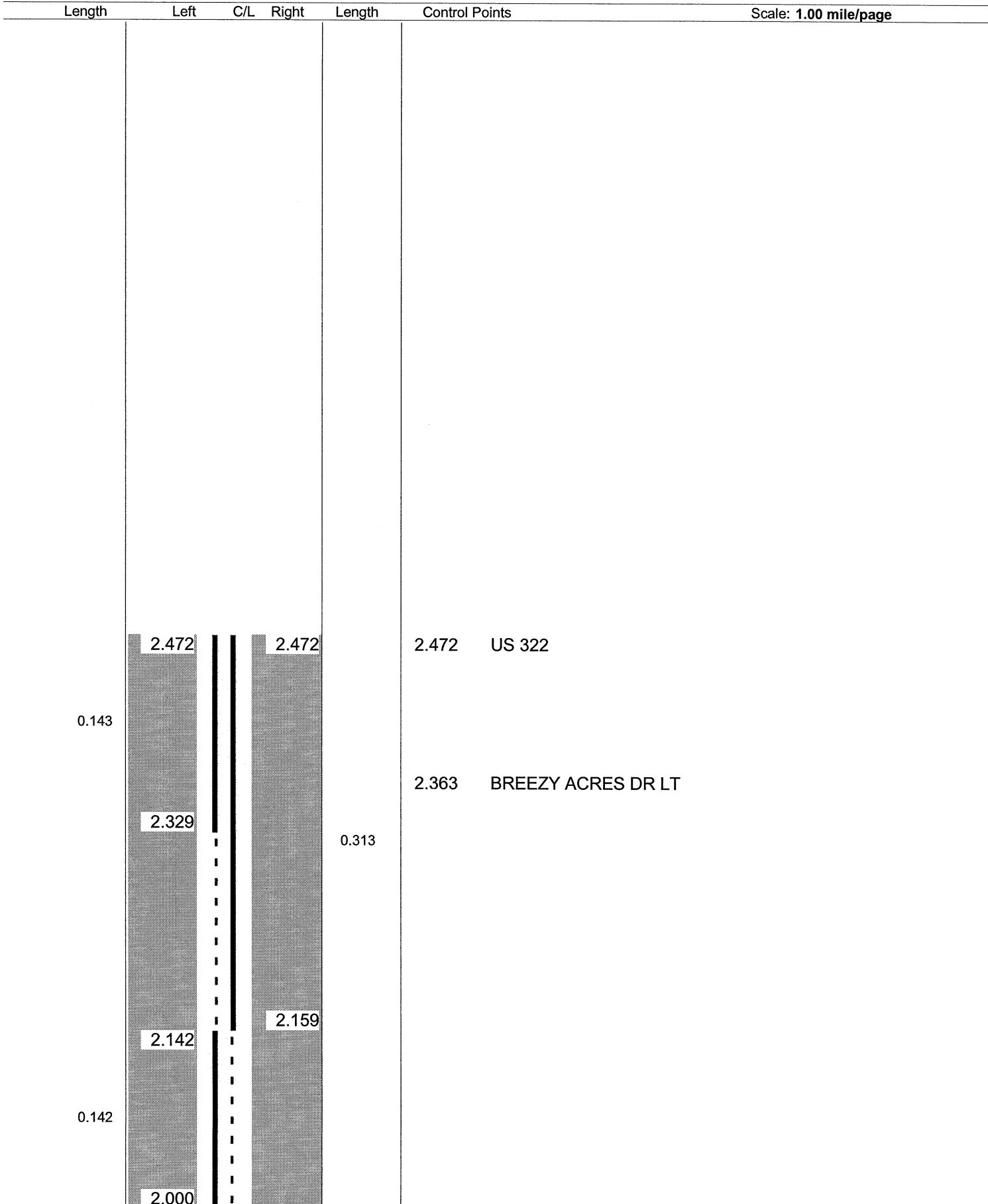

Sheet total equivalent length of solid line: 0.680

Accum. total: 3.794