

Geauga County Engineering Department
No Passing Zone Log

Route: **0002C (NELSON RD)**
 Length: **0.975**

Direction: **North**

From: **0.714 SOLTIS RD**
 To: **1.689 SR 88**

Length	Left	C/L	Right	Length	Control Points	Scale: 1.00 mile/page
	1.000		1.000			
0.287				0.287	0.947 STAGECOACH DR RT	
	0.713		0.713		0.714 SOLTIS RD LT	

Geauga County Engineering Department

No Passing Zone Log

Route: **0002C (NELSON RD)**
 Length: **0.975**

Direction: **North**

From: **0.714 SOLTIS RD**
 To: **1.689 SR 88**

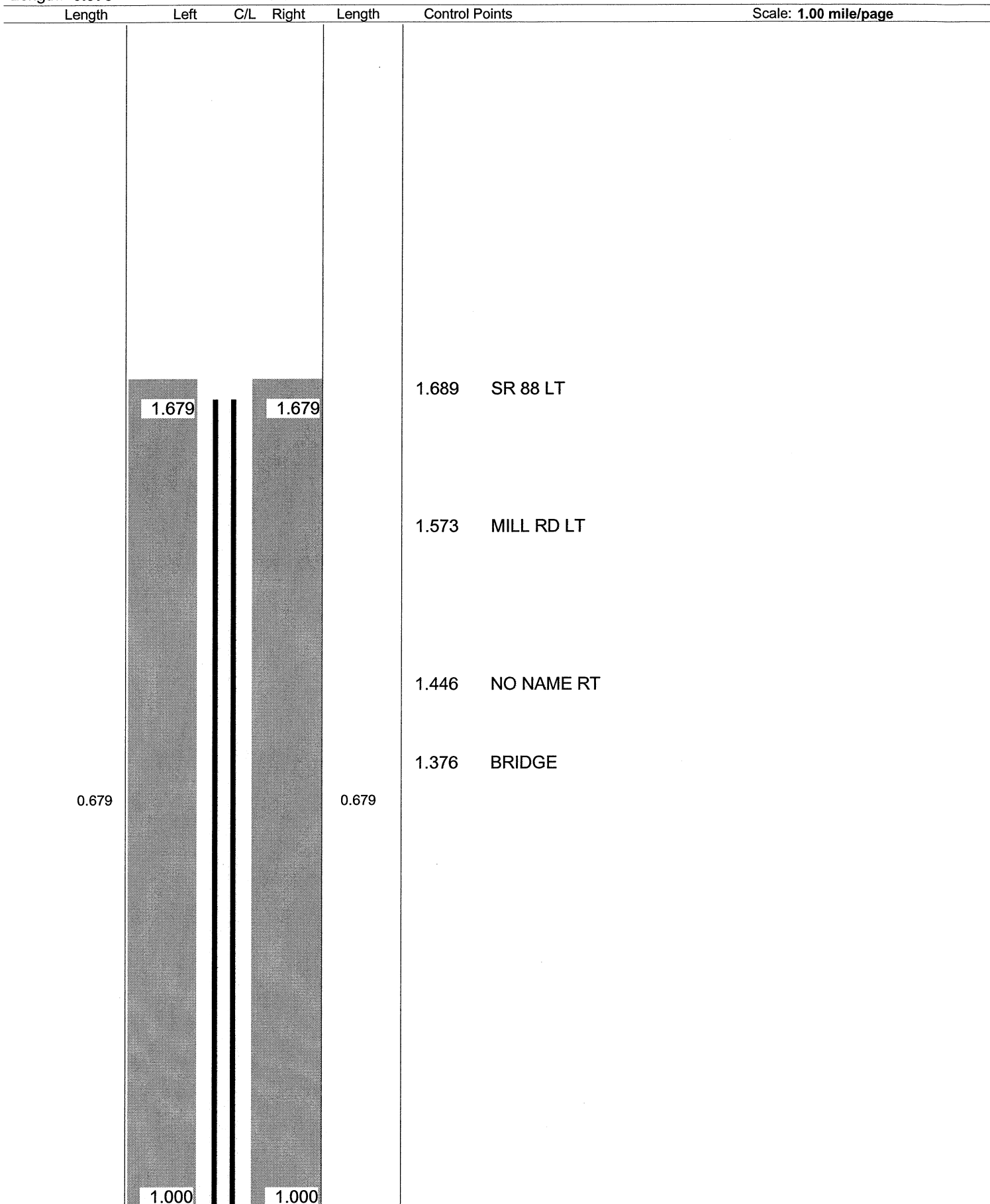

Sheet total equivalent length of solid line: 1.358

Accum. total: 1.930