

Geauga County Engineering Department

No Passing Zone Log

Route: **0024A (MUMFORD RD)**
 Length: **0.317**

Direction: **North**

From: **0.000 PORTAGE C/L**
 To: **0.317 TR 211 GROVE RD**

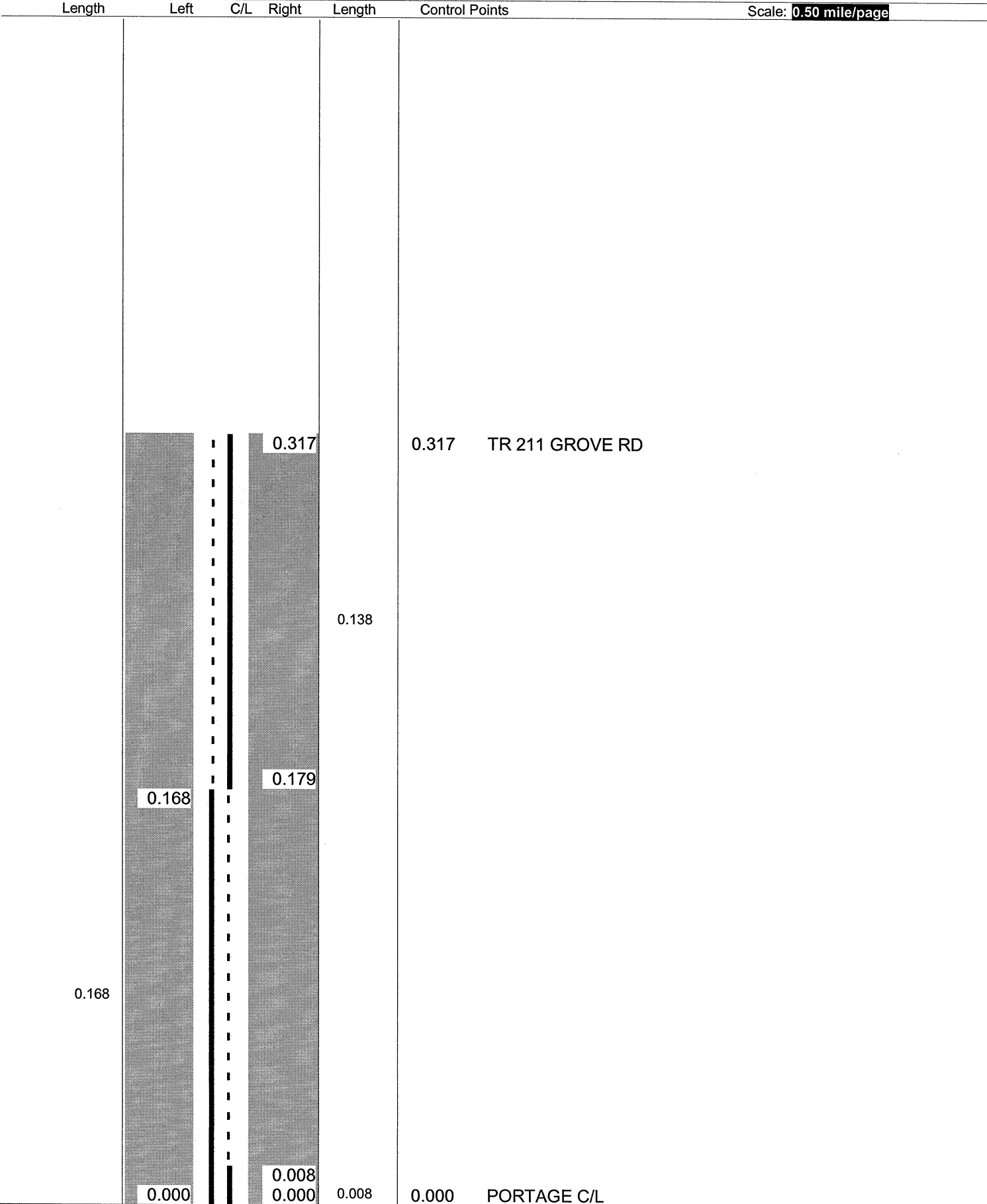

Sheet total equivalent length of solid line: 0.391

Accum. total: 0.391

Geauga County Engineering Department
No Passing Zone Log

Route: **0024B (MUMFORD RD)**
 Length: **0.771**

Direction: **North**

From: **0.317 TR 211 GROVE RD**
 To: **1.088 TR 209 HOOVER RD**

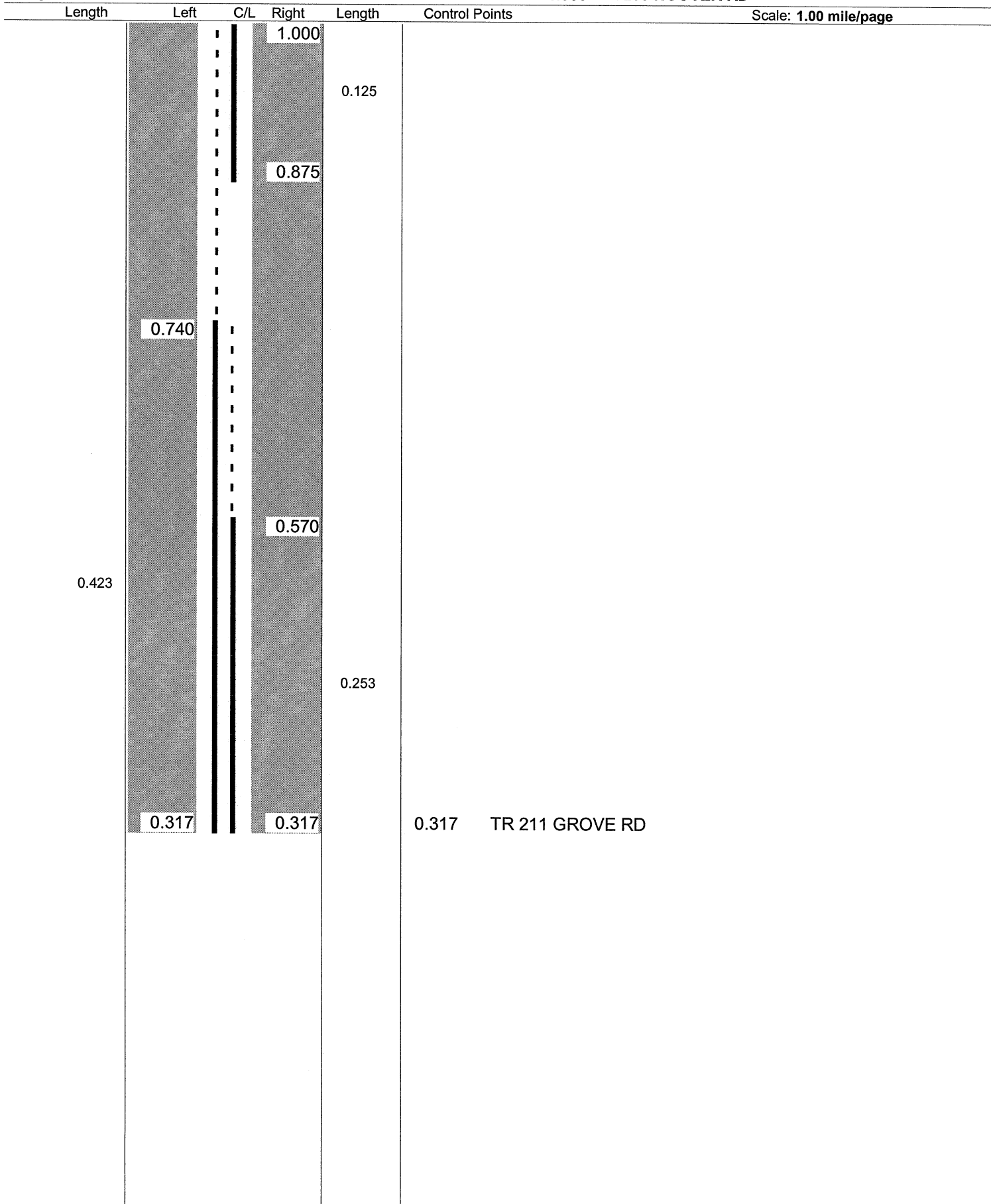

Sheet total equivalent length of solid line: 0.909

Accum. total: 0.909

Geauga County Engineering Department

No Passing Zone Log

Route: **0024C (MUMFORD RD)**

From: **1.088 TR 209 HOOVER RD**

Length: **0.166** Direction: **North**

To: **1.254 TR 210 ALGER RD**

Length	Left	C/L	Right	Length	Control Points
0.166	1.254		1.254	0.166	1.254 TR 210 ALGER RD RT
	1.088		1.088		1.088 TR 209 HOOVER RD LT

Scale: 1.00 mile/page

Geauga County Engineering Department
No Passing Zone Log

Route: **0024D (MUMFORD RD)**

Length: **0.772**

Direction: **North**

From: **1.254 TR 210 ALGER RD**

To: **2.026 US 422**

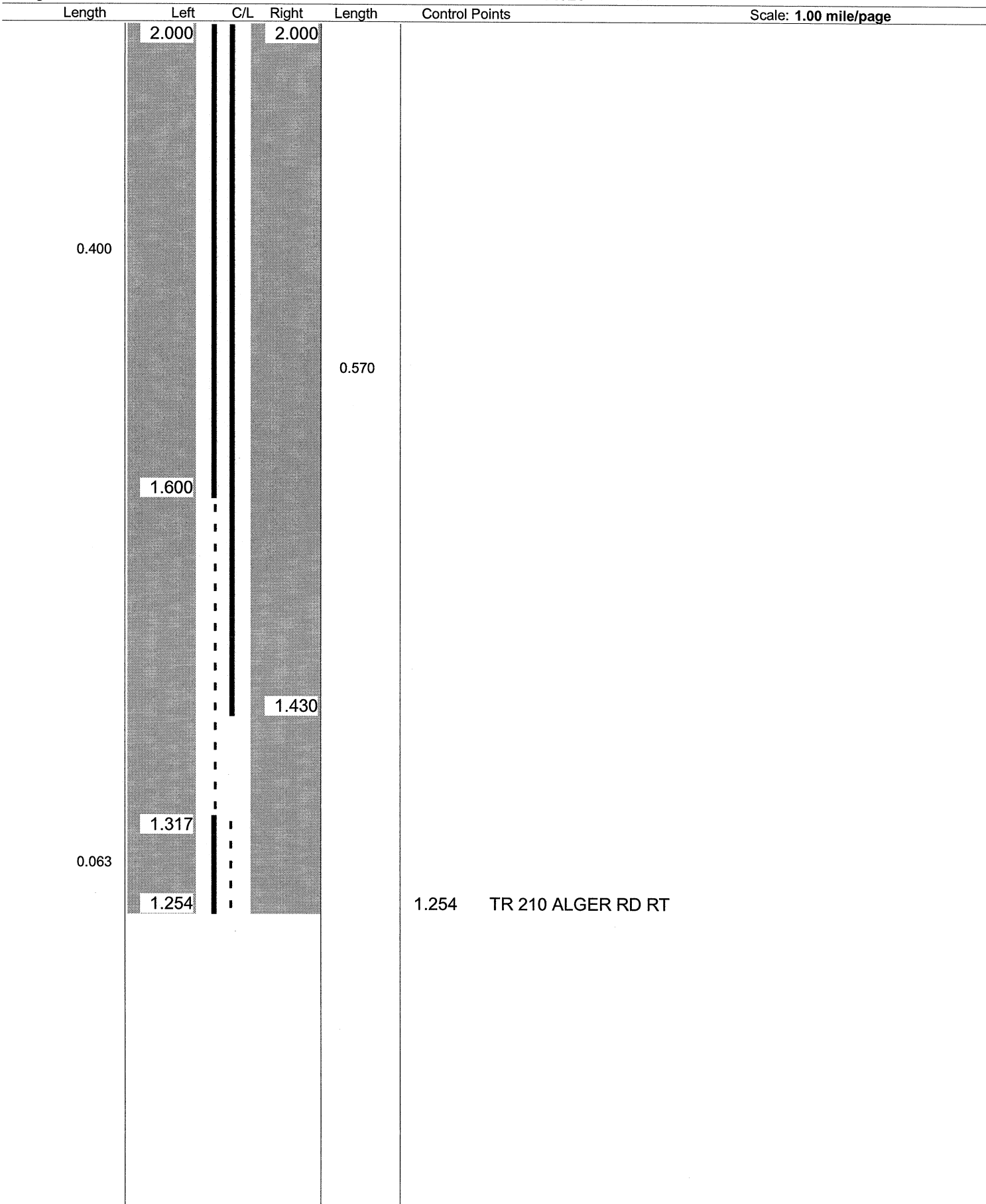

Geauga County Engineering Department

No Passing Zone Log

Route: **0024D (MUMFORD RD)**

From: **1.254 TR 210 ALGER RD**

Length: **0.772**

Direction: **North**

To: **2.026 US 422**

Length	Left	C/L	Right	Length	Control Points	Scale: 1.00 mile/page
0.018	2.018	2.000	2.018	0.018	2.026 US 422	